

# Technical data sheet

## Stapa pipe connection sleeve, without thread, hot-dip galvanised

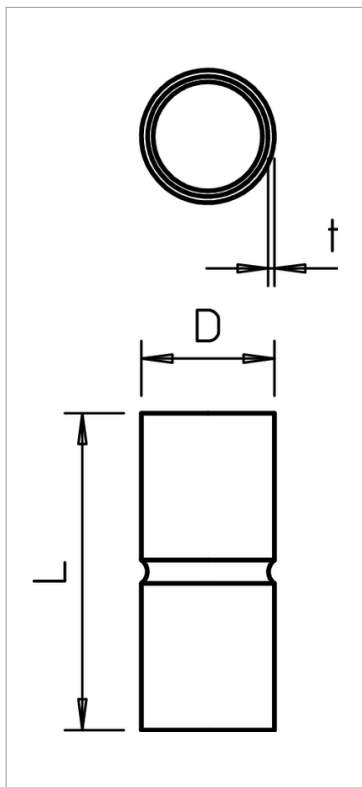

Accessory part: plug-in sleeve for the connections between electrical installation pipes. With burr-free inner wall.



Type	Dimension M	Dimension L mm	Dimension D mm	Dimension t mm	Weight kg/100 pcs.	Pack. pcs	Art-No.
SV16W FT	M16	50	18.6	1	2.400	25	2046620
SV20W FT	M20	60	23.1	1.2	4.400	50	2046621
SV25W FT	M25	60	28.1	1.2	5.600	50	2046622
SV32W FT	M32	70	35.2	1.2	7.800	50	2046623
SV40W FT	M40	80	43.8	1.5	14.400	25	2046624
SV50W FT	M50	100	54	1.5	22.000	10	2046625
SV63W FT	M63	100	67	1.5	28.000	5	2046626

**St** Steel

**FT** Hot-dip galvanised

/100

